

# How to Operate Hand Labeller

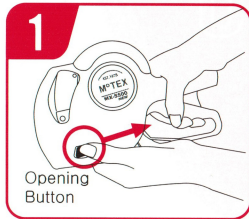

To open the base cover, pull back Opening Button Keys that are located on both sides of the labeller.

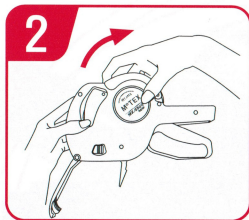

Open the cover of the label case as shown.

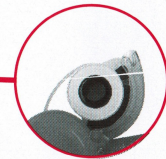
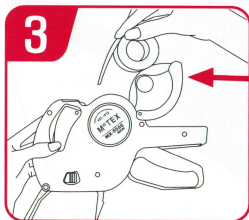

Put a label roll into the label case.

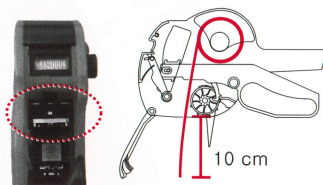
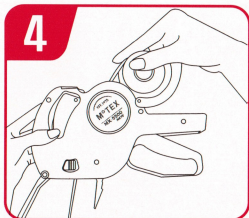

Insert label paper to the inside of the labeler and bring it out of the base until about 10cm of the label paper comes out.

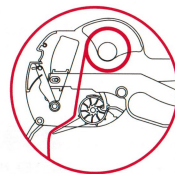
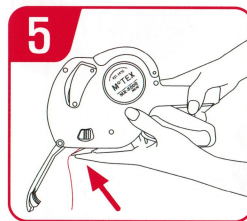

Close the base cover.

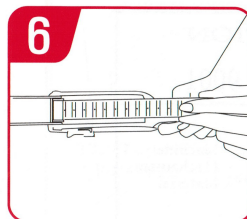

Adjust the label paper so that the holes of the paper are folded over juts of the feed roller.

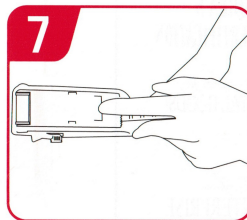
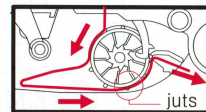

Close the base cover making sure that the label paper is tightly rolled over the feed roller.

Pull the lever of the labeller three times to feed the labels.

8

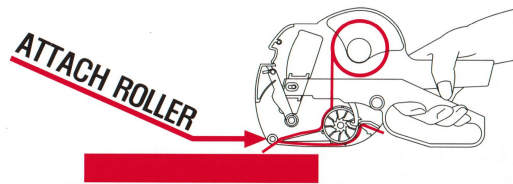

Attach labels onto your desired position of the product by sliding Attachment Roller onto the product.